



11 FOUNTAINS PLACE, NORTHALLERTON,  
DL6 1QS  
OFFERS IN THE REGION OF £500,000



Northallerton  
Estate Agency

# Fountains Place, Northallerton DL6 1QS

The property comprises brick built 5-bedroom, 3-bathroom superior substantial detached house with clay pantile roof in a highly sought after cul-de-sac on Fountains Place within walking distance of Northallerton high street and train station. The property enjoys extensive gardens with impressive views, double garage, parking for numerous vehicles, UVPC double glazing throughout, spaciouly laid out and well presented with gas fired central heating.

- 5 Bedroom 3 bathroom
- Double garage
- Sought after location
- Carport
- Detached house
- Beautiful extensive garden
- Immaculacy presented





Call us to arrange a viewing on **01609 771959**

#### Entrance

Up a step and through a composite front door with glazing to the sides providing a high degree of natural light into an entrance vestibule with flush mounted ceiling light point and etched glass door to entrance hall. Entrance hall enjoying stairs to first floor, ceiling light point, radiator, coved ceiling, door to under stairs cupboard with cloaks hanging hooks, door to downstairs W/C.

#### Downstairs W/C

Slimline duo flush toilet, unit inset washbasin with easy turn mixer taps and cupboard storage beneath, radiator, ceiling light point.

#### Sitting room

Coved ceiling, centre ceiling light point, feature fireplace comprising hardwood mantle shelf, slate hearth, space for wood burning stove, full height French doors into dining room.

#### Dining room

Coved ceiling, ceiling light point, double radiator, glazed window to side providing nice degree of natural light, archway through into kitchen diner and door to sunroom.

#### Sunroom

Wood laminate flooring, 2 x centre ceiling light points, full height French doors to side patio, radiator, TV point.

#### Kitchen

Extensive range of contemporary base and wall cupboards, wood effect worksurfaces with inset 1 ½ bowl single drain Frankie composite sink unit with quality mixer taps over, unit inset 5 ring gas hob, eye level brushed steel and glass double oven and grill, unit matched fronted fridge and freezer, space for dishwasher, tiled splashbacks, contemporary extractor over hob with light and fan, Velux roof light providing natural light, inset ceiling spotlights, radiator.

#### Downstairs shower room

Fully tiled, thermostatically controlled mains shower, duo flush toilet, unit inset washbasin with cupboard storage beneath, flush mounted ceiling light point and extractor.

#### Split landing

Window to rear and ladder to large partially boarded loft area.

#### Bedroom 1

Substantial double bedroom with wall length fitted furniture comprising wardrobes, double radiator, ceiling light point.

#### Bedroom 2

Double radiator, ceiling light point, coved ceiling.

#### Shower room

Fully tiled room with thermostatically controlled mains shower, panelled ceiling with inset ceiling spotlights, duo flush toilet, unit inset washbasin with cupboard storage beneath, shaver socket and mirror.

#### Bathroom

Fully tiled with panelled ceiling, inset ceiling spotlights, inset extractor, bath with contemporary mixer tap, unit inset washbasin with cupboard storage beneath, concealed cistern duo flush toilet, wall mounted heated towel rail, door to airing cupboard housing lag cylinder and immersion heater with shelf storage over.

#### Bedroom 3

Ceiling light point, over bed light pull, coved ceiling.

#### Bedroom 4

Over bed light pull, coved ceiling, centre ceiling light point, double radiator.

#### Bedroom 5

Wall length sliding door fronted wardrobe with internal cloaks hanging and shelf storage, ceiling light point, radiator, built in shelved storage cupboard.

#### Garden

Extensive concrete hardstanding giving access to an integral double garage with flagged parking to side, covered carport to the left of the garage provides for motorhome/caravan. Front garden is stone and brick edged raised patio and vegetable garden, nicely enclosed. Rear garden opens out to a superb garden laid to lawn with extensive manicured shrub borders with a wide range of plants and shrubs, post and plank fencing, area of natural stone flagged patio, chipped area, numerous seating areas, shed, greenhouse with stone central walkway.

#### Double Garage

Electrically operated up and over garage door to front, concrete floor, benefit of light and power, useful recessed utility area with enamel sink and cupboards beneath, space and plumbing for washing machine, space for dryer and additional appliances, fitted workbenches, wall mounted Baxi condensing central heating boiler, useful door to rear patio and garden.

VIEWING - BY APPOINTMENT THROUGH THE AGENCY - Tel. No. 01609 771959

TENURE - FREEHOLD

SERVICES - MAINS GAS, WATER, ELECTRIC & DRAINAGE

NYCC TAX BAND - F

EPC - D





GROUND FLOOR  
1168 sq.ft. (108.5 sq.m.) approx.



1ST FLOOR  
907 sq.ft. (84.2 sq.m.) approx.

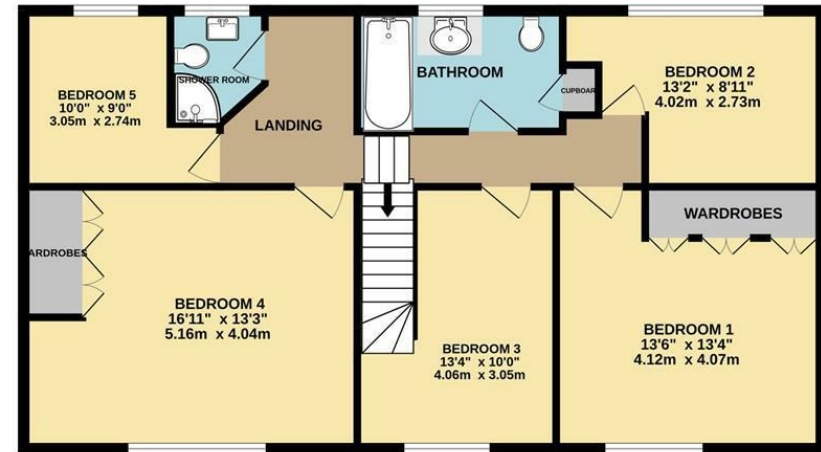

11 FOUNTAINS PLACE NORTHALLERTON NORTH YORKSHIRE. DL6 1QS

TOTAL FLOOR AREA : 2074 sq.ft. (192.7 sq.m.) approx.

Whilst every attempt has been made to ensure the accuracy of the floorplan contained here, measurements of doors, windows, rooms and any other items are approximate and no responsibility is taken for any error, omission or mis-statement. This plan is for illustrative purposes only and should be used as such by any prospective purchaser. The services, systems and appliances shown have not been tested and no guarantee as to their operability or efficiency can be given.  
Made with Metropix ©2026

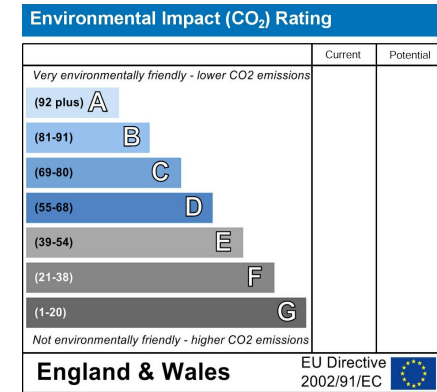
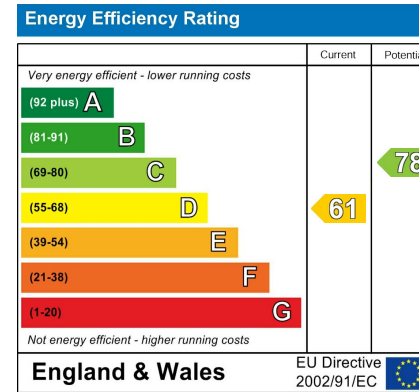

Northallerton Estate Agency does not seek to avoid our criminal and civil liabilities by the use of cleverly worded small print. Our staff have undergone training and follow set procedures, but it is not possible for us to guarantee that everything written in our sales particulars is accurate. Please note that unless stated otherwise:

- These particulars have been prepared in all good faith to give a fair and overall view of the property. If any points are particularly relevant to your interest in the property, then please ask for further information/verification
- These particulars are set out as a general outline only for the guidance for intending purchasers and do not constitute, nor constitute a part of, an offer or Contract.
- All descriptions, dimensions, measurements, distances referred to, are given as a guide only and are NOT precise. If such details are fundamental to purchase, purchasers must rely on their own enquiries. All statements do not constitute any warranty or representation by the Vendor or his/her Agents.
- We have NOT been instructed to carry out a physical survey of the property, a structural survey nor to test any of the services, fixtures, fittings or appliances which pass through, in, on, over, under or attached to the property (whether or not referred to in these particulars). Any equipment appliance or service mentioned, has not been tested by us, nor is it the subject of any guarantee.
- Any plans may not be to scale and are for identification purposes only.
- Items included in the written text are included in the sale. All others are excluded regardless of their inclusion of any photograph.
- You should place no reliance on anything stated verbally by any of our staff unless the matter is confirmed by us in writing. If any issue (included or not in these particulars) is of major important to your interest in this property, please ask us for further information.

In the event of any grievance, via our in-house complaints procedure we will consider why we may not have given you the high standards you have a right to expect from us.

143 High Street, Northallerton, North  
 Yorkshire, DL7 8PE  
 01609 771959  
 sales@northallertonestateagency.co.uk  
 www.northallertonestateagency.co.uk



**Northallerton**  
 Estate Agency